

The Peach House Floor Plan

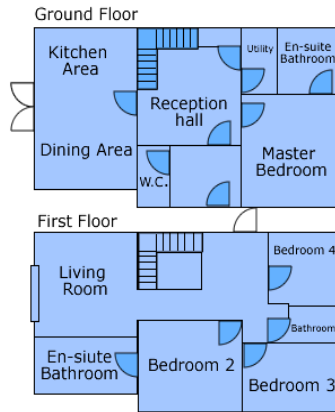

Terms and Conditions

Weekly bookings run from 3pm Friday to 10am Friday.(Except for the Xmas/New Year period). Weekend bookings run from 3pm Friday to 10am Monday (unless otherwise arranged). 4 Nights run from 3pm Monday to 10am Friday (unless otherwise arranged) Additional nights may be booked if available. To allow for complete cleaning guests must not arrive before the given time and must leave the house by 10am on the morning of departure.

Services

Central heating, bed linen and towels are provided. Please bring your own beach towels.

Deposit: A booking deposit of £100 payable to J Alexander will secure the booking and the balance is required one month prior to the holiday. All breakages must be paid for or the item replaced. In the event of a cancellation the booking deposit will be retained while we endeavour to re-let, if this is achieved we will return the deposit less any costs in re-letting.

Full Terms and conditions can be downloaded from the web site.

www.aldeburghescapes.co.uk

Aldeburgh Escapes

The Peach House

Wentworth Road, Aldeburgh, Suffolk
IP15 5BB



If you have any queries concerning The Peach House, please contact Mrs J Alexander, The Old Rectory, Old Church Road, Melton, Woodbridge, Suffolk, IP13 6DH.

Tel: Home 01394 383822
Tel: Mobile 07787 120213

Email: jennialexander@btinternet.com

Web site: www.aldeburghescapes.co.uk

The Peach House is situated in a delightfully secluded position in Aldeburgh yet just a minute from the beach and High Street Shops. Found at the end of a private brick walled driveway lined with ivy and hollyhocks this brand new house has both advantages of a sheltered lower garden and patio together with a large sun-decked terrace and small decked terrace in the garden above.



With lovely views over well tended gardens this is an idea spot to relax after a busy day exploring the Suffolk Heritage Coast. The Peach House sleeps 7 people.

The Accommodation:-

Main Hall :- with dresser containing board games etc

Large open plan Kitchen/Dinning Room:- this well equipped kitchen has a gas range oven together with dishwasher, microwave, fridge, radio and CD player. The Dinning table and chairs seat 8 people. French doors out to a sunny sheltered patio with picnic table and broly.

Utility Room:- off the hallway contains boiler controls for the heating, sink/drainer, water softener and washing machine. It is also used to store linen and cleaning equipment.

Bedroom 1:- This is a large downstairs bedroom containing a king sized bed, chest of drawers, bedside tables and fitted wardrobe plus a small TV. Ensuite bath and separate shower room with hand basin and WC.

Stairs to first Floor

Landing with table and cane seating and door out to the upper terrace and gardens. There is a small outside table and 4 chairs situated on this decked terrace.

Bedroom 2:- Contains a double 4ft bed together with bedside table fitted wardrobe and dressing table/stool. Ensuite shower room with hand basin and WC.

Bedroom 3:- Contains a 4ft Double bed abd bedside table together with fitted wardrobe with shelving.

Bedroom 4:- Contains a single 3ft 6in bed, bedside table and chest of drawers.

Living Room. This large room has double doors opening to a metal Juliette Balcony. There are two sofas and a large winged chair together with two further cane chairs and a large glass coffee table and further side tables. There is a TV, DVD and Video Player plus a collection of films to watch.

Gardens and Parking

Accessed from the landing is a private decked area to the back of the house which has a small table and 4 chairs. From here you can find the washing line and spiral staircase which takes you down to the kitchen patio.

Round the house is a raised flower bed together with a lawn and evergreen shrubs in front of a high redbrick wall which allows you complete privacy.

There is room to park three cars on the tarmac driveway together with a single garage where you can store bikes etc.

