

## The Peach House Floor Plan

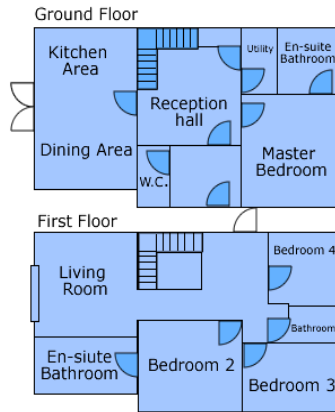

## Terms and Conditions

Weekly bookings run from 3pm Friday to 10am Friday.(Except for the Xmas/New Year period). Weekend bookings run from 3pm Friday to 10am Monday (unless otherwise arranged). 4 Nights run from 3pm Monday to 10am Friday (unless otherwise arranged) Additional nights may be booked if available. To allow for complete cleaning guests must not arrive before the given time and must leave the house by 10am on the morning of departure.

### Services

Central heating, bed linen and towels are provided. Please bring your own beach towels.

**Deposit:** A booking deposit of £100 will secure the booking and the balance is required one month prior to the holiday. All breakages must be paid for or the item replaced. In the event of a cancellation the booking deposit will be retained while we endeavour to re-let, if this is achieved we will return the deposit less any costs in re-letting.

Full Terms and conditions can be downloaded from the web site.  
[www.aldeburghescapes.co.uk](http://www.aldeburghescapes.co.uk)

## Aldeburgh Escapes

### The Peach House

Wentworth Road, Aldeburgh, Suffolk  
IP15 5BB



If you have any queries concerning The Peach House, please contact Mrs J Alexander, The Old Rectory, Old Church Road, Melton, Woodbridge, Suffolk, IP13 6DH.

Tel: Home 01394 383822  
Tel: Mobile 07787 120213

Email: [jennialexander@btinternet.com](mailto:jennialexander@btinternet.com)

Web site: [www.aldeburghescapes.co.uk](http://www.aldeburghescapes.co.uk)

The Peach House is situated in a delightfully secluded position in Aldeburgh yet just a minute from the beach and High Street Shops. Found at the end of a private brick walled driveway lined with ivy and hollyhocks this brand new house has both advantages of a sheltered lower garden and patio together with a large sun-decked terrace and small decked terrace in the garden above.



With lovely views over well tended gardens this is an idea spot to relax after a busy day exploring the Suffolk Heritage Coast. The Peach House sleeps 7 people. There is a large King-sized bedroom downstairs with a bath/shower room en-suite. On the first floor there are two double bedrooms, one en-suite, together with a with a 3'6" single bed and separate bathroom. The large fully equipped modern kitchen/diner has a gas range, microwave oven, fridge/freezer and dishwasher together with a washing machine and water softener in the utility.

The beds are equipped with all bed linen, duvets, pillows, bathroom towels and there are a number of tea and hand towels in the kitchen (please ensure you bring your own beach towels). In the living room there is a colour television and video, CD/tape player and a radio in the kitchen. We welcome all children and allow smoking but unfortunately cannot accommodate pets unless previously arranged.

The house which is fully centrally heated and double glazed, has been designed in a modern style with the upstairs living room and bedrooms having wooden flooring throughout with French doors leading directly onto a large decking area which benefits from having the sun all day. Across the landing there is also access to a small private decked terrace.

Aldeburgh High Street, with its first class restaurants, famous fish and chip shops, cafes and bars is a few minutes walk away. Here you will find good local food shops and delicatessens, as well as antiques and gifts, clothes and wines, books and picture galleries. There are two banks, a chemist, a Post Office and cinema.

The Town's merits are manifest, set on Suffolk's Heritage Coastline it can still boast a fine fishing fleet that departs from the shelved shingle beach every morning in order that we can enjoy the fresh fruits of the sea by lunch.

Inland there are many nature trails that lead you through reed beds and woodlands where you catch sight of the rare Avocets or roaming deer.

It is a wonderful venue for the sportsman as the yacht club is in sight and there are two golf courses within easy reach. There are tennis courts in the town and at the country club at Thorpeness, where there is also a lake with rowing boats.

There are tennis courts in the town and at the country club at Thorpeness, where there is also a lake with rowing boats. A few miles away at Leiston is a sports complex with a gym and a 25m swimming pool. For the less energetic there are strolls along the seafront to watch the fishermen land their catch or the occasional excitement of a lifeboat launch. Music lovers can enjoy concerts at Snape Maltings and bird enthusiasts can visit Minsmere Bird Reserve. For children who tire of the beach and the boating pond, there are two Norman castles to visit at Orford and Framlingham, a farm park at Easton and boat trips on the Lady Florence down the River Alde from Orford.

