

The Cottage Floor Plan

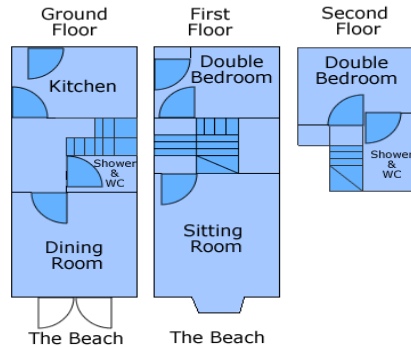

The Cottage Terms and Conditions

Weekly bookings run from 3pm Friday to 10am Friday. Weekend bookings run from 3pm Friday to 10am Monday (unless otherwise arranged) Additional nights may be booked if available. To allow for complete cleaning guests must not arrive before the given time and must leave the house by 10am on the morning of departure.

Prices include: Cleaning, Electricity, Gas, Water, Water Heating and Central Heating and the provision of duvets and pillows. Hand and tea towels are provided. We do not provide swimming towels please bring your own

Deposit: A booking deposit of £100 payable to J Balls will secure the booking and the balance is required one month prior to the holiday. All breakages must be paid for or the item replaced. In the event of a cancellation the booking deposit will be retained while we endeavour to re-let, if this is achieved we will return the deposit less any costs in re-letting.

Full Terms and Conditions for "The Cottage" can be downloaded from the website www.aldeburghescapes.co.uk

Aldeburgh Escapes

The Cottage

31a Crag Path Aldeburgh Suffolk
IP15 5BS



Aldeburgh Beach on your doorstep!

If you have any queries concerning The Cottage, please contact Mrs J Alexander, The Old Rectory, Old Church Road, Melton, Woodbridge, Suffolk, IP13 6DH.

Tel: Home 01394 383822
Tel: Mobile 07787 120213

Email: jennialexander@btinternet.com

Web site: www.aldeburghescapes.co.uk

"The Cottage" is situated in the unique location on Crag Path, Aldeburgh's renowned seafront promenade, with direct access onto the beach and only a few meters from Aldeburgh's High Street.

"The Cottage" is well equipped and designed for all-year-round use and is fully centrally heated. Bed linen and towels are provided and arrangements can be made to have the beds made-up plus bath towels.



Accommodation - The Cottage sleeps 4/6 people

The double French Doors in Crag Path lead from the sea front into the Dining Room where there is a scrubbed pine table and 8 chairs. Chest of drawers and dresser.

Lobby with downstairs shower room, hand basin and WC.

Kitchen - This well equipped kitchen has a built in electric hob and oven, microwave oven and large fridge/freezer and dishwasher.

Stairs from the lobby lead up to the first landing and Bedroom 2 with a 4ft 6 double bed, bedside table, chest of drawers and built in wardrobe.

Small flight of stairs to the Living Room. This room has commanding views of the beach and North Sea where you can sit in the bay window and watch the world literally go by. There are two sofas, one a double sofa bed and two easy cane chairs. Coffee table and side tables, TV, DVD and Video player with a number of films to watch.

Back to the landing and another short flight of stairs to Bedroom 1 which has a 4ft 6 double bed, side table, chest of drawers and fitted wardrobe. Separate shower room, hand basin and WC

The back door in the Kitchen provides access to Kings Street.

